

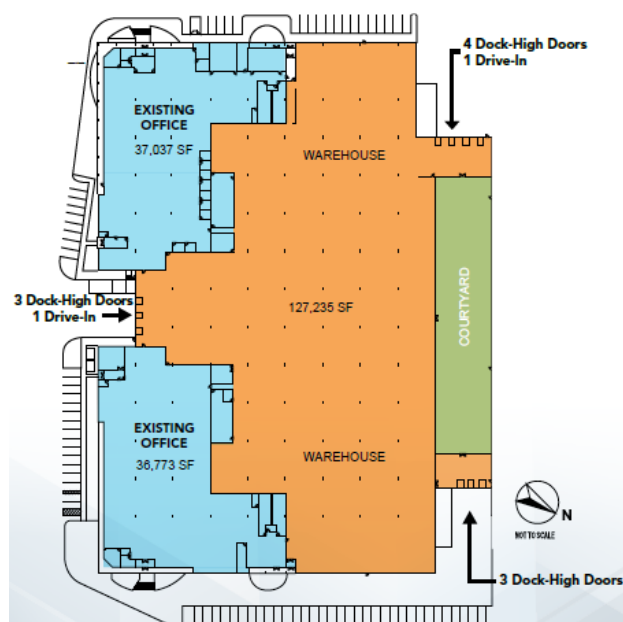

333 Centennial Parkway



General Site Information

Location	333 Centennial Parkway, Louisville, CO 80027
Owner Rep.	CBRE - Tyler Carner, Jeremy Ballenger, Jeremy Kroner, Joe Faller
Size	411,485 square feet
Zoning	Planned Community Zone District / Commercial
Asking Price	\$6.95 - \$8.50 per square foot NNN
Highway Access	.7 miles to Highway 36 at McCaslin Blvd., ~14 miles to I-25, ~18 miles to I-70, ~17 miles to
Air Access	I-76 36 miles to Denver International Airport
Rail Access	No rail access

Utility Information

Electric Power	Xcel Energy. 277/480 volts, 3-phase, 7,000 amps
Natural Gas	Xcel Energy. 3" PM, 2 psig available pressure
Water	City of Louisville. 3" water line, 1.5" irrigation line
Sewer	City of Louisville. 6" sewer line
Telecom/Fiber	CenturyLink: up to 140 MBPS, Comcast Business: up to 987 MBPS; Zayo (not yet installed to the site)

333 Centennial Parkway

Site Due Diligence Documentation Available (reports and detail available)

Title Commitment		Archeological and Historic Use Assessments	<i>Not required</i>
Aerial Site Views and Maps	<input checked="" type="checkbox"/>	Park Covenants and Restrictions	
Park Master Plan	<input checked="" type="checkbox"/>	Transportation Access Maps	<input checked="" type="checkbox"/>
Utility Service Maps	<input checked="" type="checkbox"/>	Geotechnical Study / Soil Survey	
Site Dimensions and Configuration	<input checked="" type="checkbox"/>	FEMA Flood Plain Designation with Map	<input checked="" type="checkbox"/>
Wetlands Map	<input checked="" type="checkbox"/>	Air Attainment Status	<input checked="" type="checkbox"/>
Phase 1 Environmental Assessment		Endangered Species Assessment	<i>Not required</i>

General Community Information

Community Profile and Demographics	<input checked="" type="checkbox"/>	Letters of Support	<i>N/A</i>
State and Local Incentives Overview		Business and Industrial Support Services and Amenities Profile	<input checked="" type="checkbox"/>



Economic Development Contact:

Name:

Aaron DeJong
Director

Address:

City of Louisville Economic Development
749 Main Street
Louisville, CO 80027

Email:

AaronD@louisvilleco.gov
P: 303.335.4531

Xcel Energy Contact:

Name:

Stephanie Dybsky
Manager
Corporate Economic Development

Address:

Xcel Energy
1800 Larimer Street, Suite 800
Denver, CO 80202

Email:

Stephanie.J.Dybsky@xcelenergy.com
P: 303.294.2805

XCEL ENERGY MAKES NO WARRANTY OR REPRESENTATION AS TO THE ACCURACY, QUALITY, AVAILABILITY, COMPLETENESS, OR SUITABILITY OF ANY INFORMATION CONTAINED HEREIN. All information must be independently verified. The user shall not rely on any of the information contained herein and shall assume all risk and responsibility arising from its use.