



## Northern Stacks VIII: 5101 Industrial Blvd, Fridley MN



SOUTH WEST CORNER ENTRY



SOUTH WEST CORNER



SOUTH ENTRY



EAST ENTRY

### General Site Information

Broker	Eric Batiza (952) 837-3007, eric.batiza@colliers.com
Location	5101 Industrial Blvd, Fridley MN
Size	Total 176,650 SF, including 15,196 SF Office, 164,992 SF Warehouse
Zoning	M-2: Heavy Industrial
Asking Price	Base Rent: \$6.72 PSF with 2.5% annual increases
Highway Access	1.1 miles from I-694 interchange at East River Road & I-694 to head East or West
Air Access	21.9 miles to Minneapolis St. Paul International Airport
Rail Access	Yes. BNSF: Justin Pearson (701) 667-7425

Electric Power	Xcel Energy: underground three phase services, 13.8 kV feeder (looped)
Natural Gas	CenterPoint Energy: 2" plastic, 603' gas service
Water	12 inch: City of Fridley Public Works, Engineering Division: 763.572.3552
Sewer	6 inch: City of Fridley Public Works, Engineering Division: 763.572.3552
Telecom/Fiber	Comcast Business Internet 1 Gig provides 1000 mbps upload, and 35 mbps download speeds. CenturyLink Business Advanced provides 20 mbps upload/download speeds, with some areas able to get Business Gig service with 1000 mbps upload/download speed

# Northern Stacks VIII: 5101 Industrial Blvd, Fridley MN

## Site Due Diligence Documentation Available (reports and detail available)

Title Commitment	<input checked="" type="checkbox"/>	Archeological and Historic Use Assessments	N/A
Aerial Site Views and Maps	<input checked="" type="checkbox"/>	Park Covenants and Restrictions	N/A
Park Master Plan	<input checked="" type="checkbox"/>	Transportation Access Maps	<input checked="" type="checkbox"/>
Utility Service Maps	<input checked="" type="checkbox"/>	Geotechnical Study / Soil Survey	<input checked="" type="checkbox"/>
Site Dimensions and Configuration	<input checked="" type="checkbox"/>	FEMA Flood Plain Designation with Map	<input checked="" type="checkbox"/>
Wetlands Map	<input checked="" type="checkbox"/>	Air Attainment Status	<input checked="" type="checkbox"/>
Phase 1 Environmental Assessment	<input checked="" type="checkbox"/>	Endangered Species Assessment	N/A

## General Community Information

Community Profile and Demographics	<input checked="" type="checkbox"/>	Letters of Support	N/A
State and Local Incentives Overview	<input checked="" type="checkbox"/>	Business and Industrial Support Services and Amenities Profile	<input checked="" type="checkbox"/>

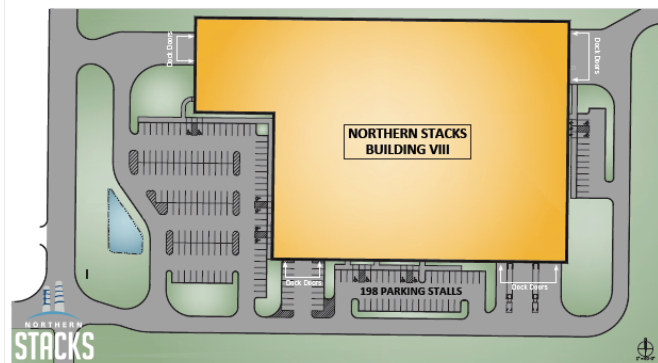
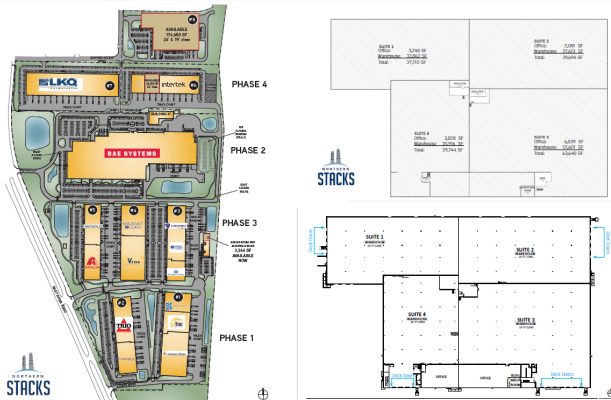

### Economic Development Contact:

**Name:**

Scott Hickok  
Community Development Director  
City of Fridley

**Address:**

City of Fridley  
6431 University Ave NE  
Fridley, MN

**Email:** [scott.hickok@fridleymn.gov](mailto:scott.hickok@fridleymn.gov)
**P:** 763.572.3590

### Xcel Energy Contact:

**Name:**

Ryan Bruers  
Manager  
Corporate Economic Development

**Address:**

Xcel Energy  
401 Nicollet Mall 07  
Minneapolis, MN 55401

**Email:**
[Ryan.L.Bruers@xcelenergy.com](mailto:Ryan.L.Bruers@xcelenergy.com)
**P:** 612.321.3186

XCEL ENERGY MAKES NO WARRANTY OR REPRESENTATION AS TO THE ACCURACY, QUALITY, AVAILABILITY, COMPLETENESS, OR SUITABILITY OF ANY INFORMATION CONTAINED HEREIN. All information must be independently verified. The user shall not rely on any of the information contained herein and shall assume all risk and responsibility arising from its use.